

Patient-Initiated Teledermatology

How it works

The Primary Care clinician requests images or a short video from the patient. The patient is:

- Provided with basic instructions if taking photos (e.g., how to take the best photos for telederm)
- Asked for relevant information
- Given a secure @nhs.net email address to send the images or video to

The Primary Care clinician receives the patient images or short video and relevant information, securely uploads them to [Consultant Connect in their browser](#), and sends the query directly to the Dermatology Team.

Using [Consultant Connect in your browser](#) to securely upload and send files:

Log in to [Consultant Connect in your browser](#) with your credentials for the app, or sign up using your NHS email address, and follow the simple steps illustrated on the diagram below

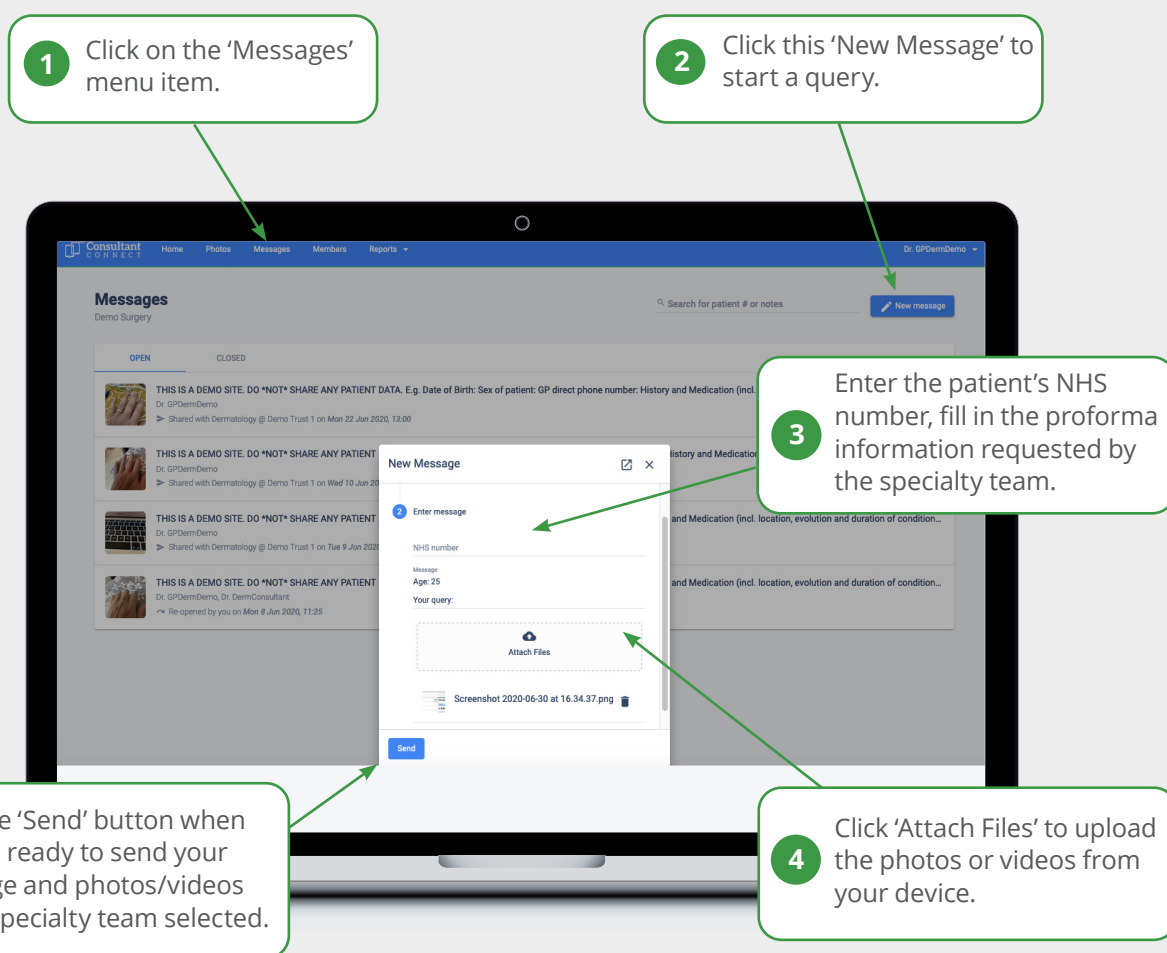

Maximum file size

Please note that when uploading files and sending them, the maximum size per file is 211MB.

For more information:

Email: hello@consultantconnect.org.uk

Call: 01865 261467